

BIG SPACE FOR BIG IDEAS

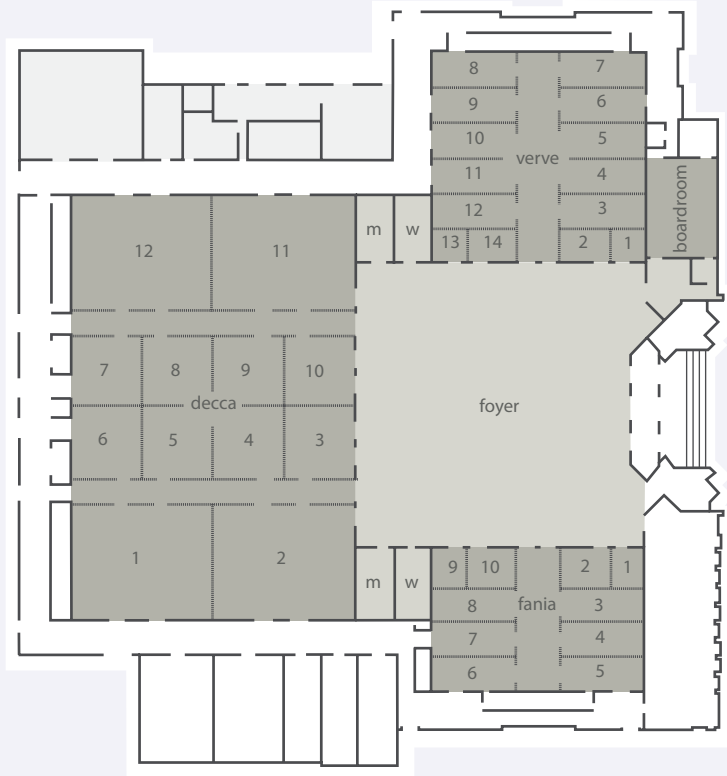

DECCA

23,755 sq ft / 2,324 sq mts

VERVE

9,400 sq ft / 841 sq mts

FANIA

6,113.57 sq ft / 567.73 sq mts

EPIC

32,291 sq ft / 3,000 sq mts

SEE THE SHOW

6,200 sq ft / 575.83 sq mts

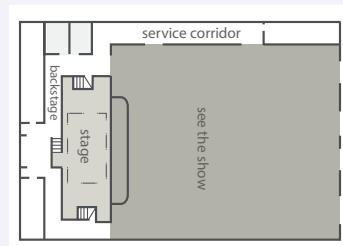
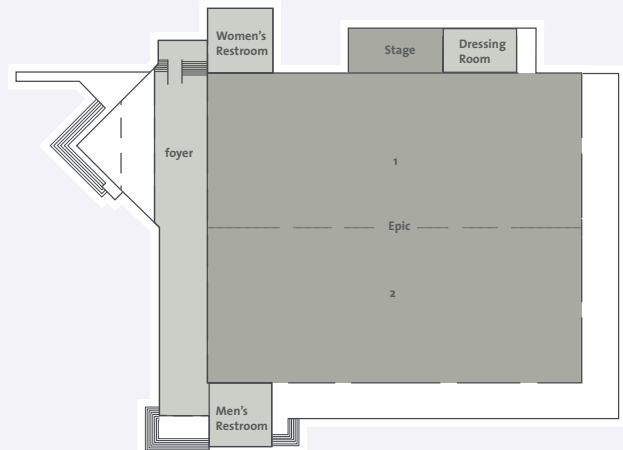

RIVIERA MAYA
AN ALL-INCLUSIVE EXPERIENCE

Km 72, Carretera Cancun-Chetumal, Puerto Aventuras, Mexico 77710

USA 001.52.984.875.1130 | INTL +52.984.875.1130 | meetings@aichotelgroup.com

Room	Dimensions Ft	Dimensions Mts	Sq Ft	M2	Ceiling Ft	Ceiling Mts	Theater	Conference	U-Shape	Banquet	Cocktail	Classroom
DECCA BALLROOM*	193.05' X 129.05'	59 X 39.4	23,755'	2,324	23'	7	2,400	—	—	1,800	2,400	1,800
decca 1,2,11,12	64.98' X 52.54'	19.8 X 16.01	3,414'	317	23'	7	330	88	68	220	330	210
decca 1&2, 11&12	130' X 52.54'	39.6 X 16.01	6,830'	633	23'	7	660	168	148	440	660	420
decca 3-10	31.1' X 31.88'	9.4 X 9.7	991.4'	91.18	23'	7	80	36	27	60	100	60
VERVE BALLROOM*	98.75' X 98.15'	30.09 X 29.91	9,400'	841	13.8'	4.2	870	—	—	610	870	610
verve 1,13	15.51' X 15.76'	4.72 X 4.8	244.43'	22.65	13.8'	4.2	20	12	12	10	20	10
verve 2,14	22.53' X 15.76'	6.86 X 4.8	355.07'	33	13.8'	4.2	30	16	12	20	30	20
verve 3-12	38.42' X 15.76'	11.71 X 4.8	605.5'	56	13.8'	4.2	50	32	28	36	50	36
FANIA BALLROOM*	63.63' X 96.08'	19.39 X 29.28	6,113.57'	567.73	13.8'	4.2	570	—	—	400	570	360
fania 1,9	15.28' X 16.83'	4.65 X 5.12	257'	23.8	13.8'	4.2	20	8	12	10	20	10
fania 2,10	22.75' X 16.83'	6.93 X 5.12	382.88'	35.48	13.8'	4.2	30	16	12	20	30	20
fania 3-8	38.03' X 16.83'	11.6 X 5.12	640.04'	59.39	13.8'	4.2	50	32	28	36	50	36
FOYER CONVENTION CENTER	118' X 131'	36 X 40	15,458'	1,440	13.8'	4.15	—	—	—	900	1,200	—
EPIC BALLROOM*	164.04' X 196.85'	50 X 60	32,291'	3,000	23'	7	3610	—	—	2,710	3,818	2,242
epic 1/2	82.02' X 196.85'	25 X 60	16,145.63'	1,500	23'	7	1,805	—	100	1,355	1,710	1,120
epic foyer	200.62' X 22.96'	61.15 X 7	4,606.23'	428.05	—	—	—	—	—	—	900	—
Outdoor Venues in Heaven												
eden bar	—	—	—	—	—	—	—	—	—	40	100	—
starlight terrace	—	—	—	—	—	—	—	—	—	240	350	—
starlight garden	—	—	—	—	—	—	—	—	—	110	250	—
cross current pool	—	—	—	—	—	—	—	—	—	50	80	—
semi-olympic pool	—	—	—	—	—	—	—	—	—	80	150	—
heaven terrace	—	—	—	—	—	—	—	—	—	180	300	—
toro terrace	—	—	—	—	—	—	—	—	—	50	80	—
toro garden	—	—	—	—	—	—	—	—	—	40	70	—
stairway to heaven	—	—	—	—	—	—	—	—	—	—	300	—
club heaven terrace	—	—	—	—	—	—	—	—	—	40	70	—
heaven overlook	—	—	—	—	—	—	—	—	—	30	50	—
sunset terrace	—	—	—	—	—	—	—	—	—	—	80	—
central heaven beach**	—	—	—	—	—	—	—	—	—	250	340	—
toro beach**	—	—	—	—	—	—	—	—	—	180	250	—
Main Building Hacienda Side												
see the show	86' X 72.9'	26.21 X 22.97	6,200'	575.83	21'	6.5	600	—	—	360	600	360
Outdoor Venues in Hacienda												
arpa terrace	—	—	—	—	—	—	—	—	—	60	90	—
chichen gazebo	—	—	—	—	—	—	—	—	—	50	80	—
woodstock terrace	379.4' X 106'	115.64 X 32	40,216.4'	3,700	—	—	—	—	—	3,000	4,000	—
woodstock deck	160' X 40'	48 X 12	6,400'	576	—	—	—	—	—	350	550	—
pandero gazebo	—	—	—	—	—	—	—	—	—	40	70	—
pandero terrace	—	—	—	—	—	—	—	—	—	40	60	—
chapel terrace	—	—	—	—	—	—	—	—	—	40	60	—
lobby hacienda terrace	—	—	—	—	—	—	—	—	—	40	60	—
ipanema beach	—	—	—	—	—	—	—	—	—	60	80	—
maracas beach	—	—	—	—	—	—	—	—	—	80	150	—
maracas terrace	—	—	—	—	—	—	—	—	—	350	400	—
hacienda overlook	—	—	—	—	—	—	—	—	—	40	60	—
backyard	—	—	—	—	—	—	—	—	—	50	80	—
backyard basketball	—	—	—	—	—	—	—	—	—	80	110	—
central hacienda beach**	—	—	—	—	—	—	—	—	—	400	600	—
solarium ipanema**	—	—	—	—	—	—	—	—	—	360	550	—

* Space is divisible.

** According to the Union policies, a surcharge of \$12 USD per person applies.