

# NOBU HOTEL

CHICAGO



Offering 115 stylishly appointed guest rooms and suites, Nobu Hotel Chicago is centrally located in Chicago's West Loop. The Hotel is brought to life in a theatrical way through the architecture of the building, which playfully blends elements of old world Japanese art and new world utilitarian, with a sense of accessible sophistication. Darker, raw accents come through with the use of blackened steel, which ties back to the industrial history of the West Loop.

## DETAILS

- 115 Guest rooms including 23 suites
- Guest rooms: 360 - 400 f<sup>2</sup> / 33 - 37 m<sup>2</sup>
- Suites: 500 - 1950 f<sup>2</sup> / 46 - 181 m<sup>2</sup>
- Exclusive Nobu beds
- Natura Bissé bath amenities
- Bathtubs/soaking tubs and walk-in showers
- Private bar
- Nespresso machine and traditional Japanese tea service
- In-room dining by Nobu Restaurant
- Preferred seating at Nobu Restaurant
- Nightly turndown service
- High-Speed WiFi
- 60-inch Smart TV
- Mobile check-in available
- Yoga mats

## DINING

- Nobu Restaurant
- The Rooftop at Nobu Hotel Chicago (indoor and outdoor)

## WELLNESS

- Tranquility pool
- State-of-the-art fitness center equipped with Technogym
- Men & women locker room facilities with steam rooms

## MEETING & EVENTS

- 3,245 square feet of meeting and event space located on the 10th floor
- Natural daylight
- Catering by Nobu Restaurant
- 2 Private dining rooms
- Rooftop with skyline views

## EXPLORE

In the center of Chicago's West Loop Neighborhood and famed "Restaurant Row," Nobu Hotel Chicago has an ideal location in the center of the city's energy and flavor. The selection of attractions within these few blocks are astounding. Guests can explore the following attraction:

- The Loop – 0.8 miles/ 6 minutes
- United Center – 1.4 miles/ 7 minutes
- Michigan Avenue – 1.5 miles /9 minutes
- The Art Institute of Chicago – 1.7 miles / 12 minutes
- Millennium Park 1.8 miles/ 11 minutes
- Navy Pier – 2.5 miles/ 15 minutes
- Cinescape Chicago Film Studios – 2.9 miles/ 13 minutes
- Shedd Aquarium – 3.3 miles/ 14 minutes
- Adler Planetarium – 3.6 miles/ 15 minutes
- McCormick Center – 4.6 miles/ 11 minutes
- Soldier Field – 5.2 miles/ 9 minutes
- Field Museum – 5.2 miles/ 9 miles
- Museum of Science and Industry – 9.1 miles/ 14 minutes

## LOCATION

- Chicago Midway Airport - 30 min drive
- O'Hare International Airport - 30 min drive



# MEETING & EVENT SPACE CAPACITY

ROOM NAME	Sq. Ft.	W x L (Ft)	W x L (M)	Ceiling Height (Ft)	Banquet	Classroom	Conference	Crescent Rounds	Reception	Theater	Ushape
Kawa	2,088	62 x 40	19 x 12	11	120	100	56	72	160	140	50
Kawa I	1,044	31 x 20	10 x 6	11	60	50	28	36	80	70	25
Kawa II	1,044	31 x 20	10 x 6	11	60	50	28	36	80	70	25
Private Dining Room	630	44 x 30	13 x 9	10	EXISTING BOARDROOM TABLES FOR 32						
PDR I	315	22 x 15	7 x 5	10	EXISTING BOARDROOM TABLE FOR 16						
PDR II	315	22 x 15	7 x 5	10	EXISTING BOARDROOM TABLE FOR 16						
Private Dining Room Foyer	680	52 x 14	16 x 4	10	-	-	-	-	32	-	-
Rooftop	4,967	96 x 44	29 x 13	9	EXISTING LOUNGE FURNITURE FOR 200						
Rooftop - Interior	2,120	-	-	9	EXISTING LOUNGE FURNITURE FOR 150						
Rooftop - Exterior	2,847	-	-	-	EXISTING LOUNGE FURNITURE FOR 50						

KAWA  
2,088 sq ft

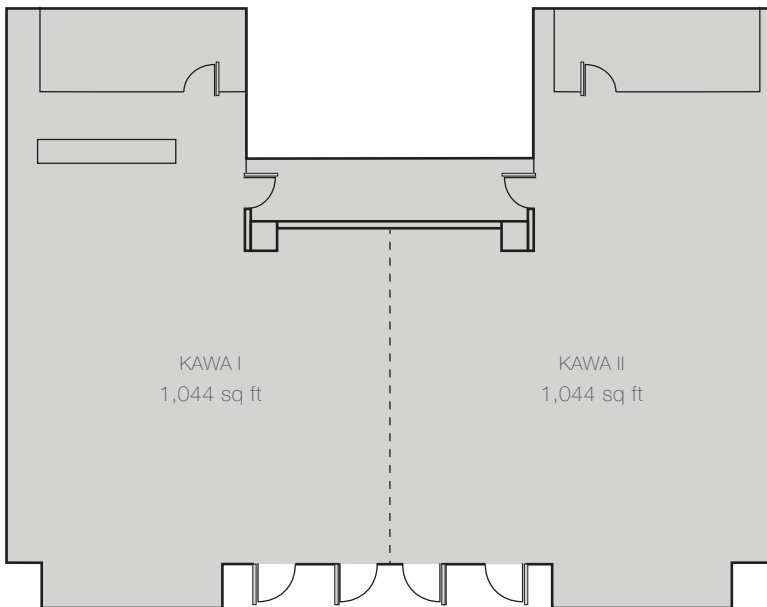

PRIVATE DINING ROOM  
630 sq ft

